

Phase 2: Car dealership

The car dealership fronts the south-eastern proposed boundary, with the car showroom and car sales parking facing both Westbourne Street and Baker Street, with ALDI to the north.

The workshop frontage lies to the west and looks onto the customer and workshop parking allowing for access.

Tree planting will soften the edges and the access to the site at East Richardson Street.



An example of a car showroom entrance

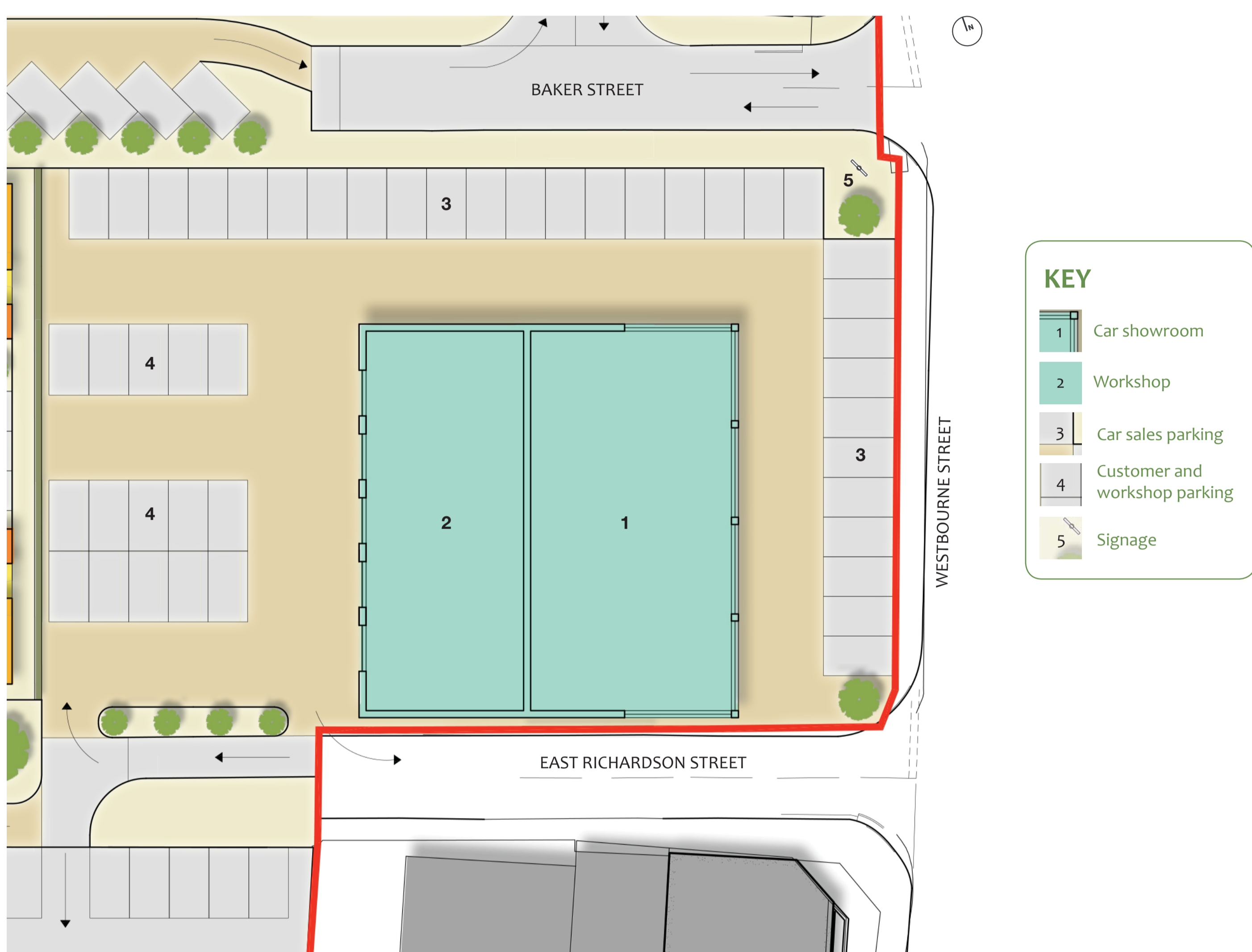

Schematic plan - car dealership



An example of car sales parking



An example of a workshop and workshop parking

